

PANEL CUT-OUT

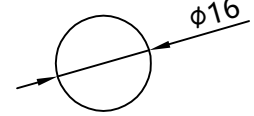

Circuit

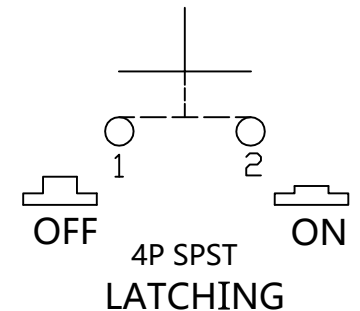

The Main Technology Performance

Item	Parameter
Rated voltage Rated current	3A 250VAC
Insulated resistance	DC 500V 100M Ω min
Contact resistance	50m Ω Max
Dielectric strength	AC 1500V 1 minute
Operating Temperature	-25 $^{\circ}$ C ~ +85 $^{\circ}$ C
Electrical Life	\geq 10000 Cycles

No.		Version		Layout drawing	Only For Reference	
Design						
Check				PBS16-503AD	BITUD ELECTRIC CO.,LTD	
Process						
Standard						
Verified						
Approved						